

SUPER Averaging Beam

Mini-Line®

The SUPER averaging beam enables the ability to average out the deviations of the existing pavement surface thereby obtaining a smoother mat. It is designed to feature four - six sensors that take individual measurements across the entire length of the averaging beam, and the average of these measurements constitutes the base of grade regulation. Rough spots in the existing foundation, which would normally affect the quality of the new road, are effectively smoothed out.

The SUPER Averaging Beam is a straight beam that consists of four to six sections, depending on the length required. The main section is mounted on the tow arm with Mountings clamped or bolted onto the tow arm, and each additional section is easily mounted with locking hinges. Each section features internal cabling and six plugs, which makes it easy to install and switch positions of up to six sonic sensors. The plugs can also be used to connect lights (add-on), just as the Averaging Beam can be connected to the controller very flexibly from any available plug. The sensor mounting rods feature Snap Connectors for easy sensor mounting, and can accommodate both G221 Ultrasonic Grade Sensors and G224 Multi-Sonic Sensors.

The beam profile provides for a very stable construction, and support rings locking all adjustable parts, marks the preferred settings and secure a fast mounting for the next job.

The flexible Hinge (add-on) enables the operator to place the sensor furthestmost back over the paved mat.

SUPER Averaging Beam Specifications

Part Number	S-51650 (9 m / 29,5 ft) S-51651 (13,2 m / 43 ft)
Application	Grade control Non contact ground sensing
Storage Temperature	-40°C to 85°C / -40°F to 185°F
Operating Temperature	-10°C to 70°C / 14°F to 158°F
Type	Straight Beam



Mini-Line® SUPER Averaging Beam
13m / 40ft (6 sections)

SUPER Averaging Beam

Mini-Line®

Bolt Mountings for Tow Arm

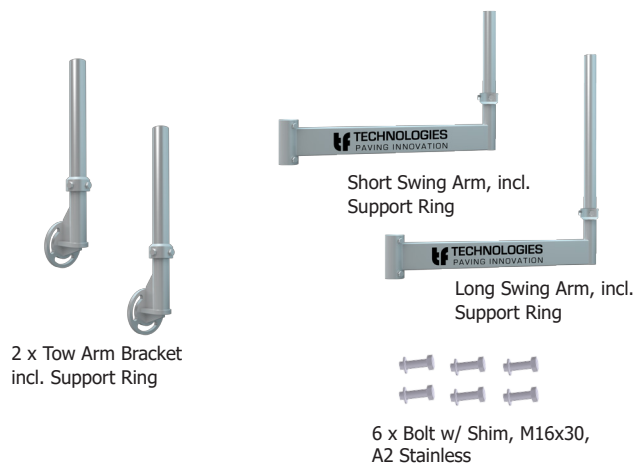

Part Number SP-51607

Main Section w/ Clamp Brackets

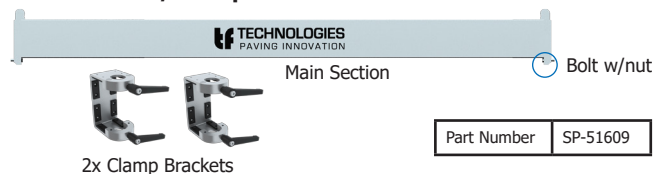

Part Number SP-51609

Extension Section w/ Bolt

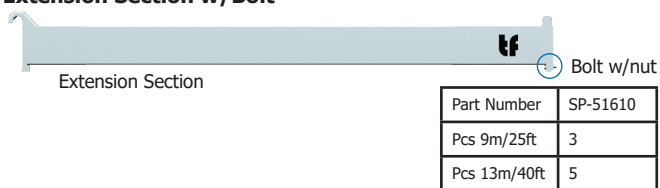

Part Number	SP-51610
Pcs 9m/25ft	3
Pcs 13m/40ft	5

Sensor Mounting Rod w/ Snap Connector and Support Ring



Connection Cable for Beam



Part Number S-51600/1.5

Cable, Beam to Sensor



Part Number S-51601/1.5

V-Cable for SUPER Beam



Part Number S-51604

Add-on: Clamping Plates Kit for Tow Arm

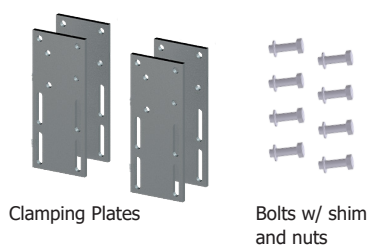

Part Number SP-51628

Add-on: Hinge

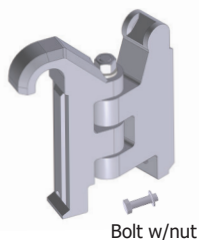

Part Number SP-51608

Add-on: SAB Light set (4 pcs)



Part Number SP-51612

SUPER Averaging Beam

Mini-Line®

Mini-Line® SUPER Averaging Beam 9m / 25ft (4 sections)



Part Number	S-51650
Length	9 meters / 29.5 feet
Weight	63 kg / 139 lbs
Sections	4
Plugs	24

Mini-Line® SUPER Averaging Beam 13 m / 40ft (6 sections)



Part Number	S-51651
Length	13.2 meters / 43 feet
Weight	87 kg / 192 lbs
Sections	6
Plugs	36